

J1

AR30.10-P-1010D

Adjusting accelerator control

**ENGINE 104.941 /942 /943 /944 /991 /992 /994,
111.920 /940 /941 /944 /960 /961 /975 up to 31.8.96**

Engine 104

**Shown on model 124 with automatic
transmission**

- 24 Accelerator pedal
- 30 Accelerator control cable
- 30/2 Adjusting nut
- 30/3 Adjusting screw
- 30/5 Guide piece
- 30/7 Driver spring
- 32/2 Drag lever
- 32/4 Connecting rod
- 32/5 Bell crank
- 32/6 Fulcrum lever
- 32/7 Control lever
- 32/8 Roller
- 32/9 Connecting rod
- 38 Variable full throttle stop
- 98 Control pressure control cable
- 98/2 Adjusting screw
- S16/7 Kickdown switch, 2nd transmission mode

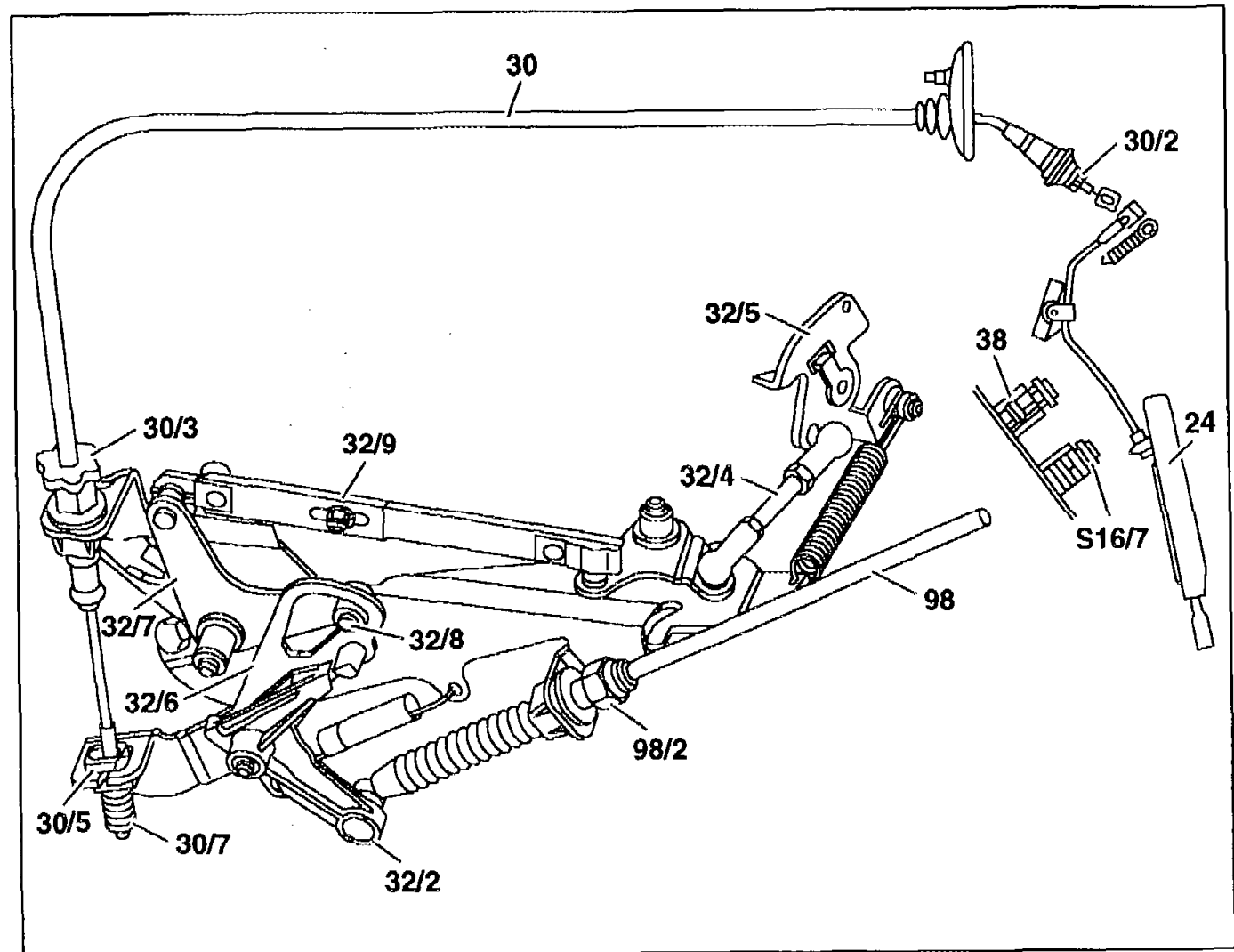

Engine 111

Shown on model 124 with automatic transmission

- 24 Accelerator pedal
- 30 Accelerator control cable
- 30/2 Adjusting nut
- 30/3 Adjusting screw
- 30/5 Guide piece
- 30/7 Driver spring
- 32/2 Drag lever
- 32/4 Connecting rod
- 32/5 Bell crank
- 32/6 Fulcrum lever
- 32/7 Control lever
- 32/8 Roller
- 32/11 Connecting rod (cruise control only)
- 32/12 Drag lever (cruise control only)
- 32/13 Control shaft (cruise control only)
- 38 Variable full throttle stop
- 98 Control pressure control cable
- 98/2 Adjusting screw
- M16 Cruise control (CC) actuator (cruise control only)
- S16/7 Kickdown switch, 2nd transmission mode

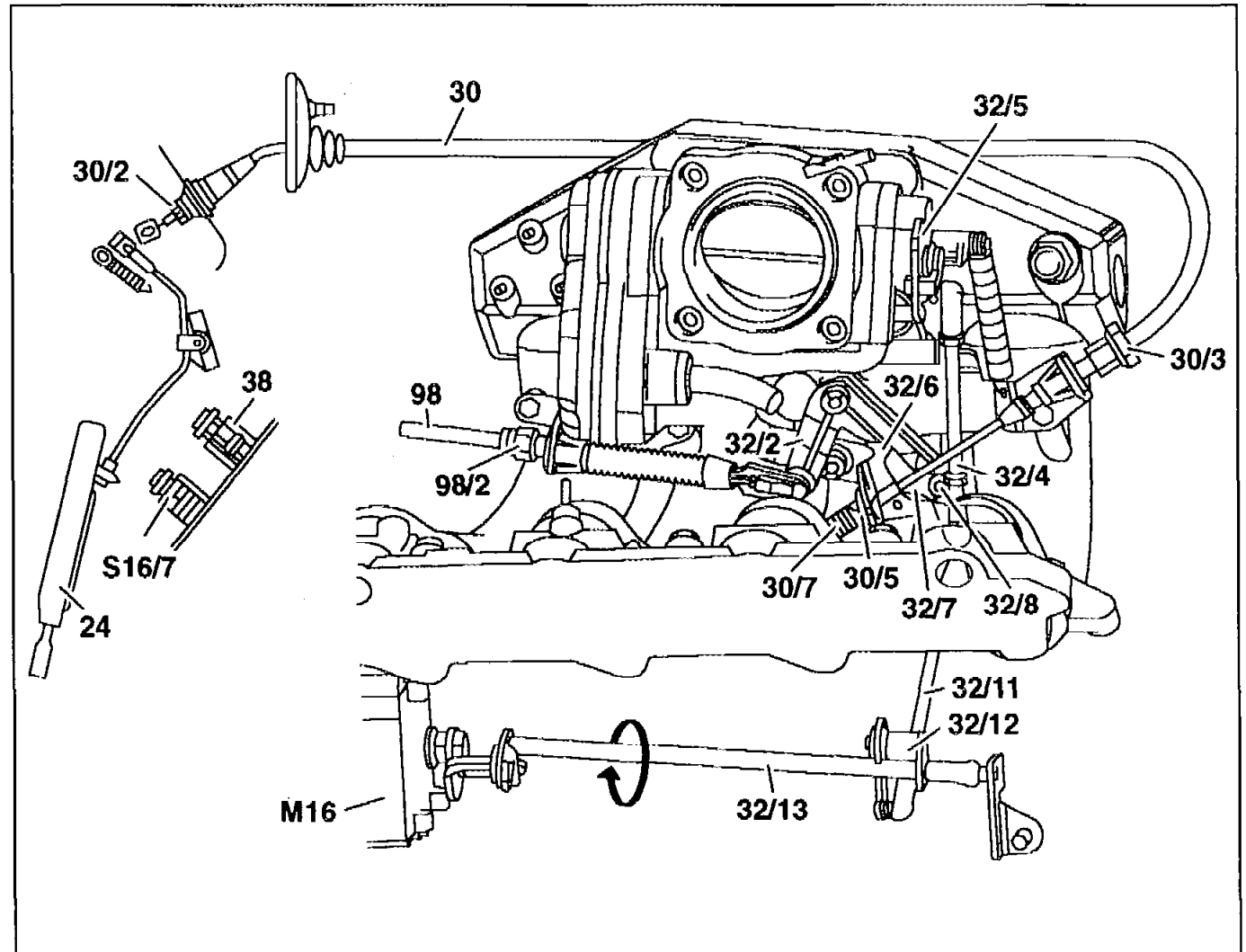



Left-hand illustration: closed throttle position (idle) stop (arrow)
 Shown on engine 104

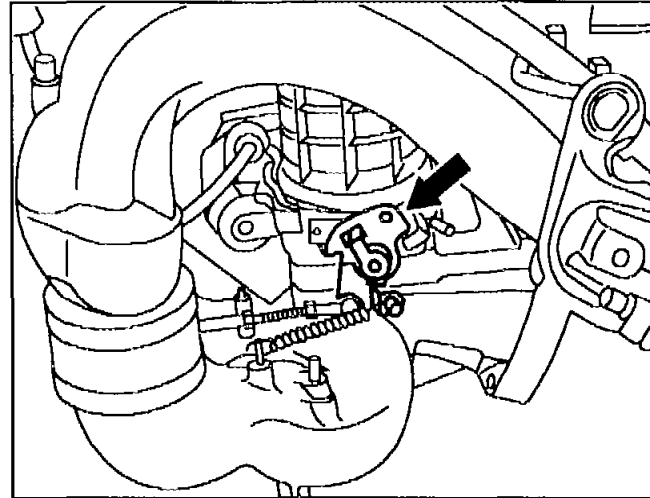

P30.10-0217-01

Right-hand illustration: full throttle stop (arrow)
 Shown on engine 104

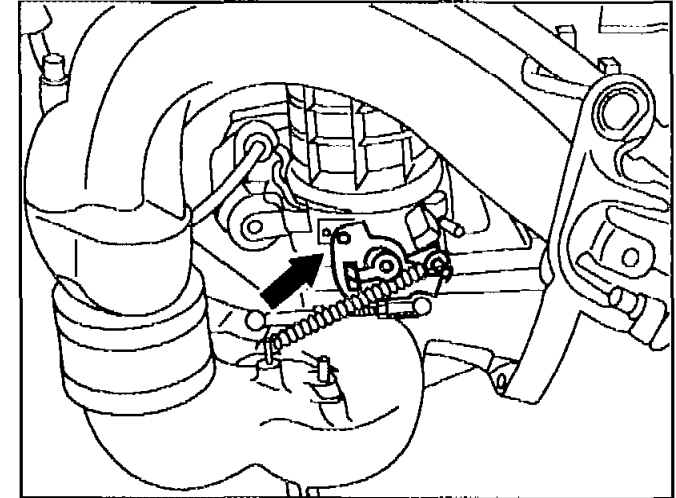

P30.10-0218-01

Left-hand illustration: engine 111

- 1 Ball pin
- 2 Ball socket
- 32/4 Connecting rod

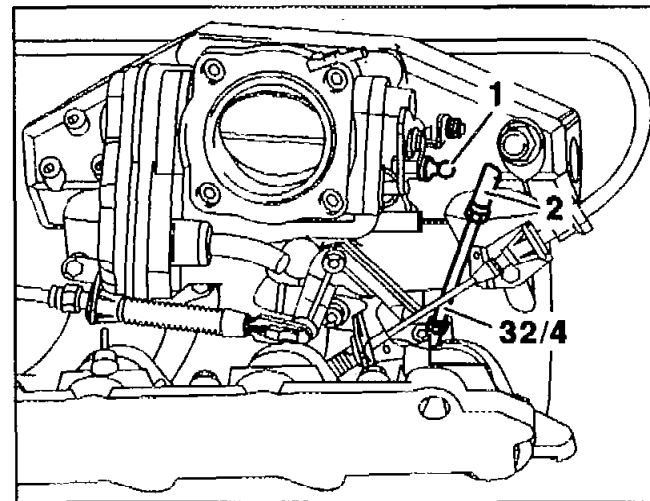

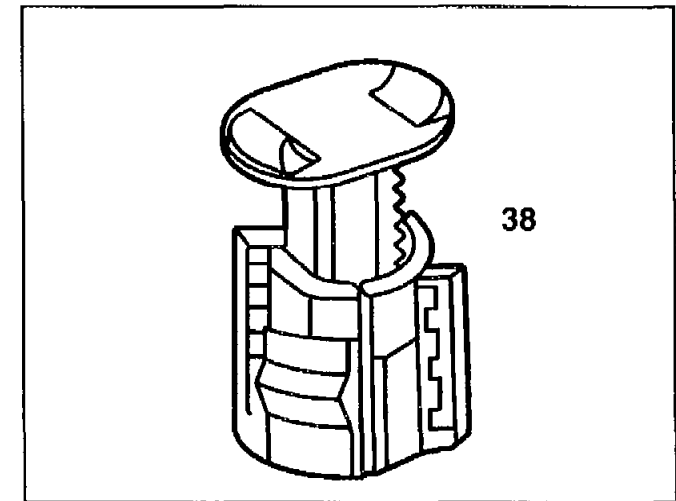

P30.10-0222-01

Right-hand illustration:
 38 Variable full throttle stop (in footwell)



P30.10-0219-01



	Adjusting		
	Ignition: OFF		
1	Inspect connecting rods (32/4, 32/9) and accelerator control cable (30) to ensure they operate freely and are in proper condition	Replace parts, if necessary	
2	Check play between driver spring (30/7) and guide piece (30/5), adjust	There must be play between driver spring (30/7) and guide piece (30/5). Set with adjusting screw (30/3), if necessary	BE30.10-P-1001-01A
3	Detach connecting rod (32/4) at one end and check closed throttle position (idle) stop	Bell crank (32/5) must be resting against closed throttle position (idle) stop of idle speed control actuator	
4.1	Attach connecting rod (32/4) free of tension	Engine 104: connecting rod (32/4) must remain set to a fixed size. Measure between centers of ball sockets.	BE30.10-P-1002-01A
4.2	Adjust connecting rod (32/4)	Engine 111: Position connecting rod (32/4) at ball pin free of tension (fig.). Shorten connecting rod (32/4) by turning ball socket (2) in 2 turns, attach and lock  The adjustment of the connecting rod (32/4) must be performed very accurately. The microswitch for the idle speed control must be operated when doing this (closed)	BE30.10-P-1002-01A



5	Idle speed adjustment at engine end Check setting of control lever (32/7), adjust	Engine 104: The roller (32/8) in the control lever (32/7) must be resting free of tension against the end stop of the fulcrum lever (32/6). Adjust fulcrum lever (32/6) with connecting rod (32/9), if necessary, so that roller (32/8) is resting free of tension against the end stop	
6	Adjust control pressure control cable (98)	With control pressure control cable attached, turn adjusting screw (98/2) until the tip of drag lever (32/2) is at the same level as the tip of the fulcrum lever (32/6)	
7.1	Checking full throttle stop, adjusting Anti-twist lock of WOT stop enlarged	Manual transmission: With engine switched off, depress accelerator pedal (24) to full throttle stop. Bell crank (32/5) must be resting against full throttle stop of idle speed control actuator. Release variable full throttle stop (38), if necessary, by turning to the left. Pull out stop pin slightly, lock full throttle stop (38) in position by turning to the right. Models 124, 129, 202	BT30.10-P-0003-01A B18





7.2		Automatic transmission: With the engine switched off, depress accelerator pedal (24) to full throttle stop at kickdown switch (S16/7) (do not operate kickdown switch). Bell crank (32/5) must just be resting against the full throttle stop of the idle speed control actuator; set with adjusting screw (30/3), if necessary	
8	Checking idle speed adjustment at chassis end, adjusting	Accelerator pedal (24) in idle speed position. There must be play between driver spring (30/7) and guide piece (30/5); adjust from inside car with adjusting nut (30/2), if necessary	
9	Grease accelerator control cable (30) between end piece and guide piece (30/5) with anti-corrosion grease		BR00.45-Z-1007-06A
10.1	Adjust connecting rod (32/11)	i Only on engine 111 with cruise control. Detach connecting rod at one side. Guide piece (30/5) should be in closed throttle position. Turn control lever (32/7) clockwise (arrow) as far as the stop (closed throttle position). Turn drag lever (32/12) clockwise until it touches the control shaft (32/13). Now adjust connecting rod (32/11) so that it can be attached free of stress.	

**Test values of accelerator control**

Number	Designation		Engine 104	Engine 111
BE30.10-P-1001-01A	Play of accelerator control cable between driver spring and guide piece at fulcrum lever	mm	0.5–1.0	0.5–1.0
BE30.10-P-1002-01A	Length of connecting rod to bell crank (fixed dimension)	mm	84	-

Repair product

Number	Designation	Order number
BR00.45-Z-1007-06A	Anti-corrosion grease	001 989 37 51 10