

46-520 Checking idler arm play, R and R idler arm bushing

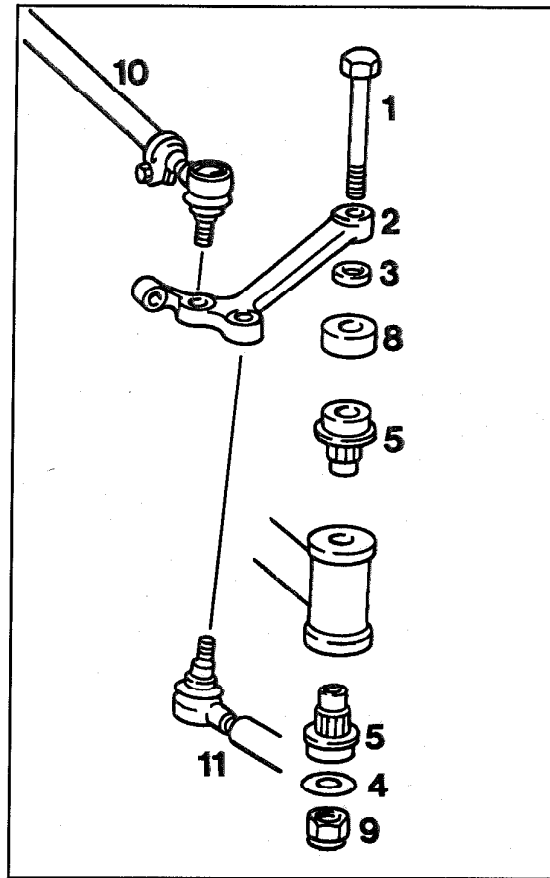

P46-5046-17

Idler arm (2)	check bearing play, max. 0.5 mm. Use magnetic holder 363 589 02 21 00 (steps 1-3).
Tie rod (10)	remove from idler arm, install (46-540) (step 4).
Center link (11)	remove from idler arm, install (46-550) (step 5).
Self-locking nut (9)	screw off, screw on and replace, 180 Nm.
	Remove sealing washer (4), install (step 6).
Bolt (1)	screw out, screw in. Remove idler arm (2), spacer (3) and dust cap (8), install (step 7).

46-520 Checking idler arm play, R and R idler arm bushing

Idler arm (2)	check, observe code (46-050) (step 8).
Rubber bushing (5)	replace. Use puller 129 589 00 33 00. Lubricate rubber bushing. Use installation tool 115 589 08 61 00 (steps 9-10).
Ball point position	check, adjust, if required (40-320).

Special tools

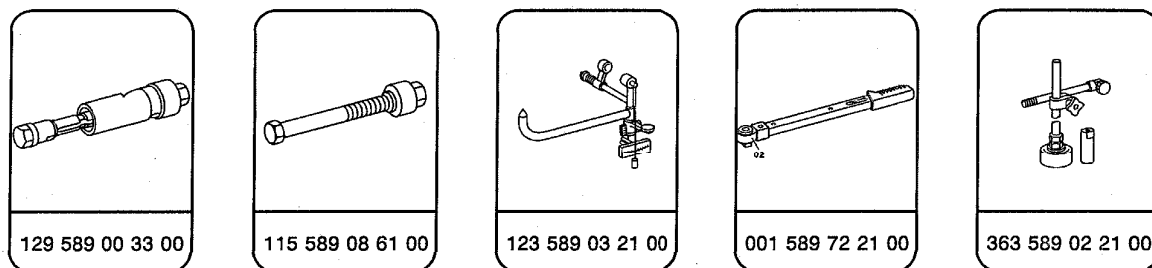

Commercially available tool

Dial gauge A1 DIN 878

e. g. Mahr,
D-7300 Esslingen
Order no. 810

46-520 Checking idler arm play, R and R idler arm bushing

Checking bearing play

- 1 Attach dial gauge (030) with magnetic holder (040) 363 589 02 21 00 to bottom of frame so that dial gauge (030) is at right angle to idler arm (2).
- 2 Position probe tip of dial gauge (030) between mounting cones on steering linkage. Set scale on dial gauge (030) to "0".
- 3 Read off play in rubber bushings on dial gauge (030) (max. 0.5 mm) by pressing idler arm (2) up and down (arrows) with two fingers (average force 50-70 N).

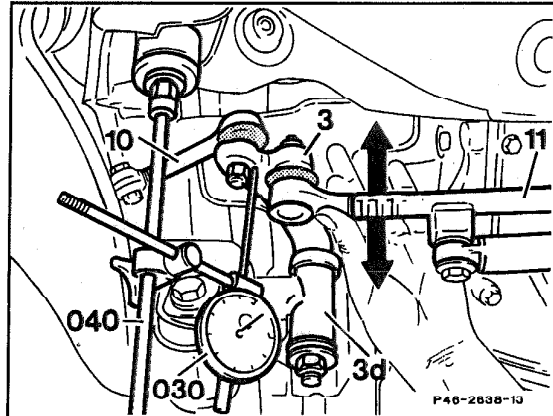

P46-2638-13A

Removal and installation

- 4 Remove tie rod at idler arm, install (46-540).
- 5 Remove center link at idler arm, install (46-550).

46-520 Checking idler arm play, R and R idler arm bushing

6 Screw self-locking nut (9) off of bolt (1), remove sealing washer (4).

Installation note

Replace self-locking nut.

At least one complete thread should be visible on the bolt after tightening the self-locking nut. Tightening torque 180 Nm.

7 Screw out bolt (1) and remove idler arm (2), spacer (3) and dust cap (8).

- 5 Rubber bushing
- 5a Bushing
- 6 Idler arm bearing

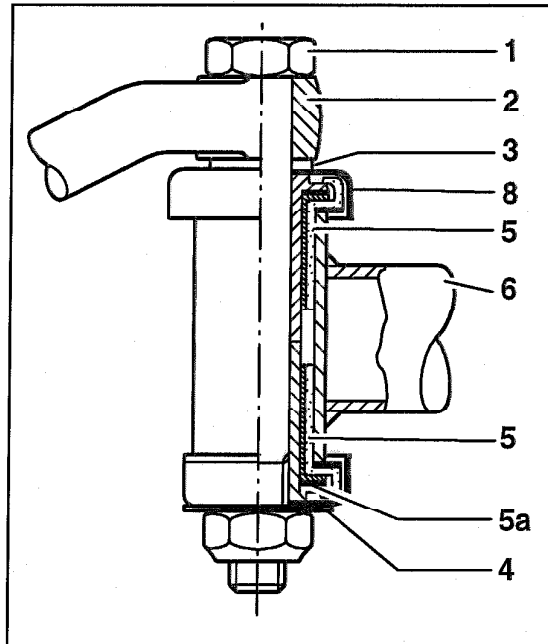

P46-0048-15

8 It is not possible to check the idler arm with equipment available in the workshop. In cases of doubt, particularly following an accident, replace the idler arm. Check code (arrow) (46-050).

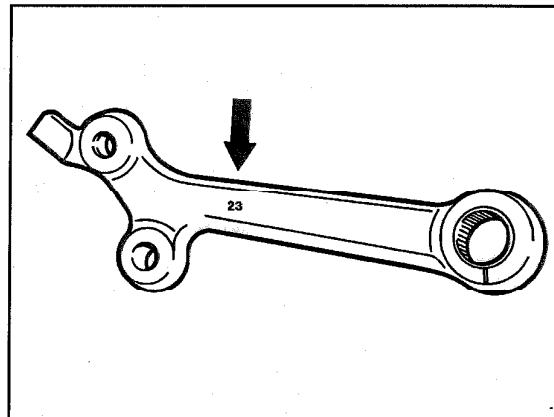

P46-2390-13

9 Replace rubber bushing in idler arm bearing. For this purpose pull up sealing lip on rubber bushing with screwdriver and remove bushing (5a) from rubber bushing.

Knock stop for rubber bushing (arrows) off of bearing tube with suitable punch.

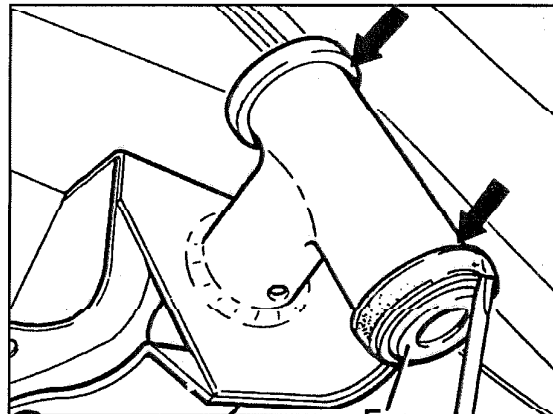

P46-2389-13A

46-520 Checking idler arm play, R and R idler arm bushing

10 Pull both inner sleeves for rubber bushing out of idler arm bearing (6) with puller (061) 129 589 00 33 00.

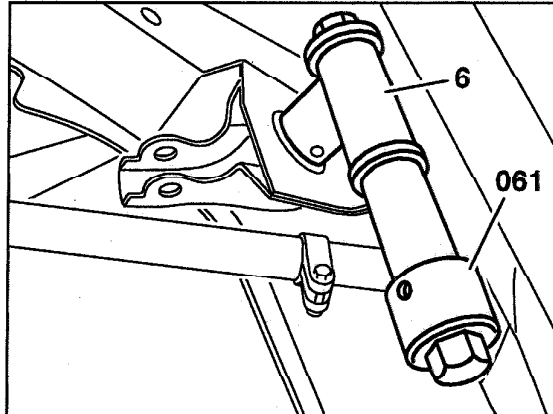

P46-2391-13A

Installation note

Coat outside of rubber bushing (5) with lubricant, e.g. white oil, and press into idler arm bearing (6) with installation tool (062) 115 589 08 61 00.

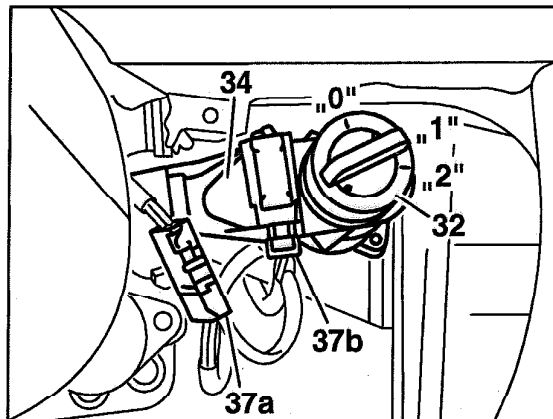

P46-2384-13

11 Check ball point position and adjust, if required (40-320).