

82-0052 R and R head lamp unit

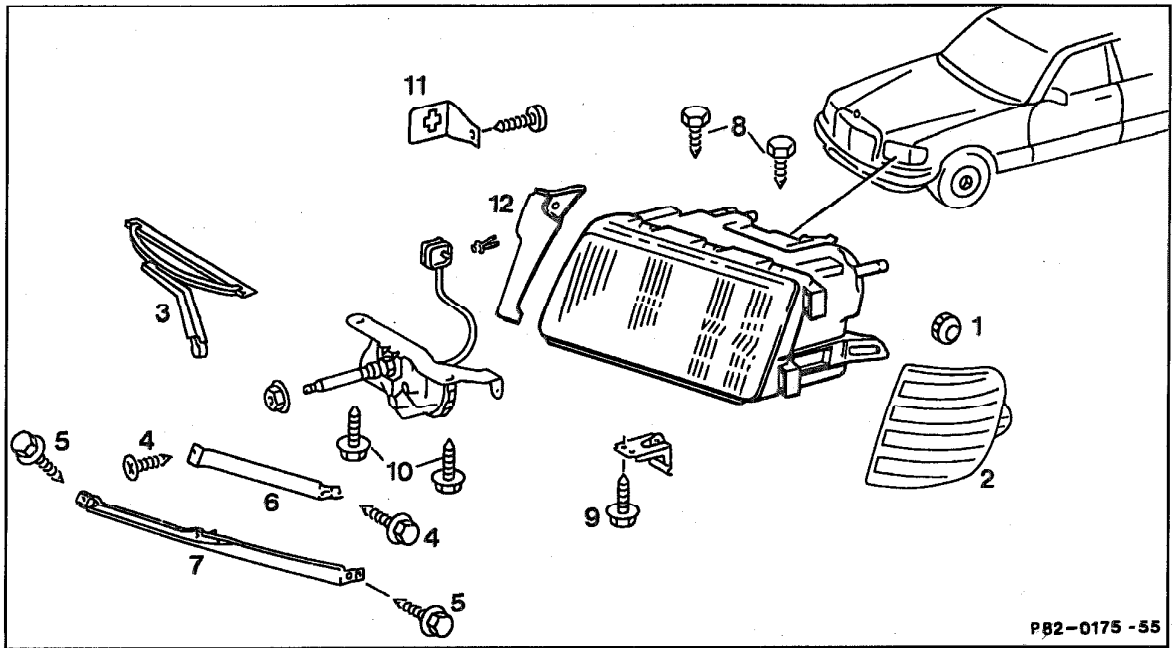

P82-0175 - 55

P82-0175-55

Knurled nut (1)	screw out, screw in.
Turn-signal lamp (2)	push forward and remove at the side, push in from the front.
Electrical connection	pull off, push on.
Wiper arm (3) only vehicles with headlamp cleaning system (HCS)	remove, reinstall.
Mounting screws sedan (4), coupe (5)	turn out, turn in.
Cover sedan (6), coupe (7)	remove, fit.
Cover (USA) (12)	unclip, pull up and remove, fit and clip in.
Mounting screws (8 and 9 or 10)	turn out, turn in.
Lamp unit	remove, install from the front.
Electrical connection	pull off, fit.
Bracket (11) only vehicles with HCS	unscrew, screw on.
Lighting	adjust front (82-0040).