



A5

AR47.10-P-7000E

Removing and installing fuel gauge sender

3.8.94

MODEL 202, 208**Fuel tank system of gasoline engines**

84/4 Pipes of suction spray pump

89/2 Shaped seal

B4/1 Fuel gauge sensor, left half of tank

B4/2 Fuel gauge sensor, right half of tank

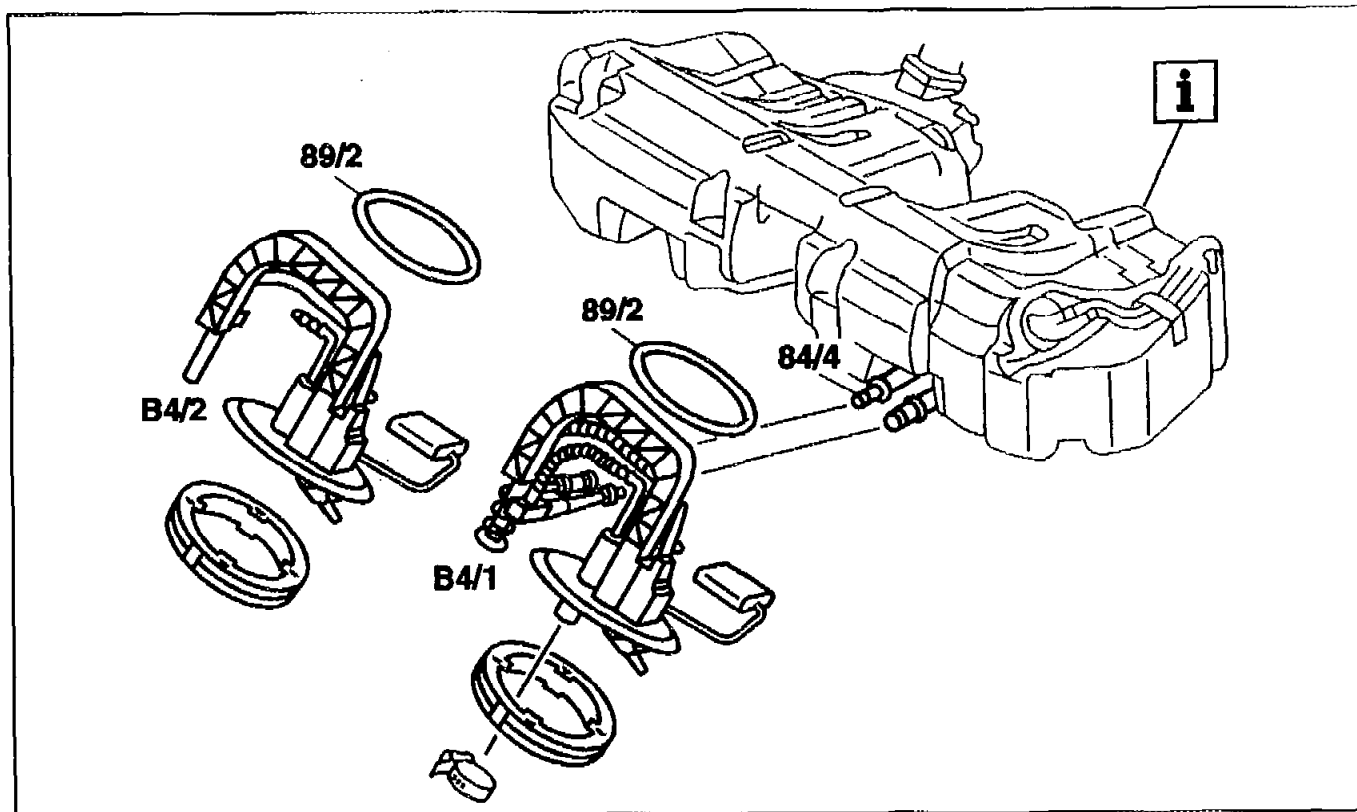

Fuel tank system of diesel engines

84/4 Pipes of suction spray pump

89/2 Shaped seal

B4/1 Fuel gauge sensor, left half of tank

B4/2 Fuel gauge sensor, right half of tank

Y23 Fuel metering pump (only on model 202.133/193)

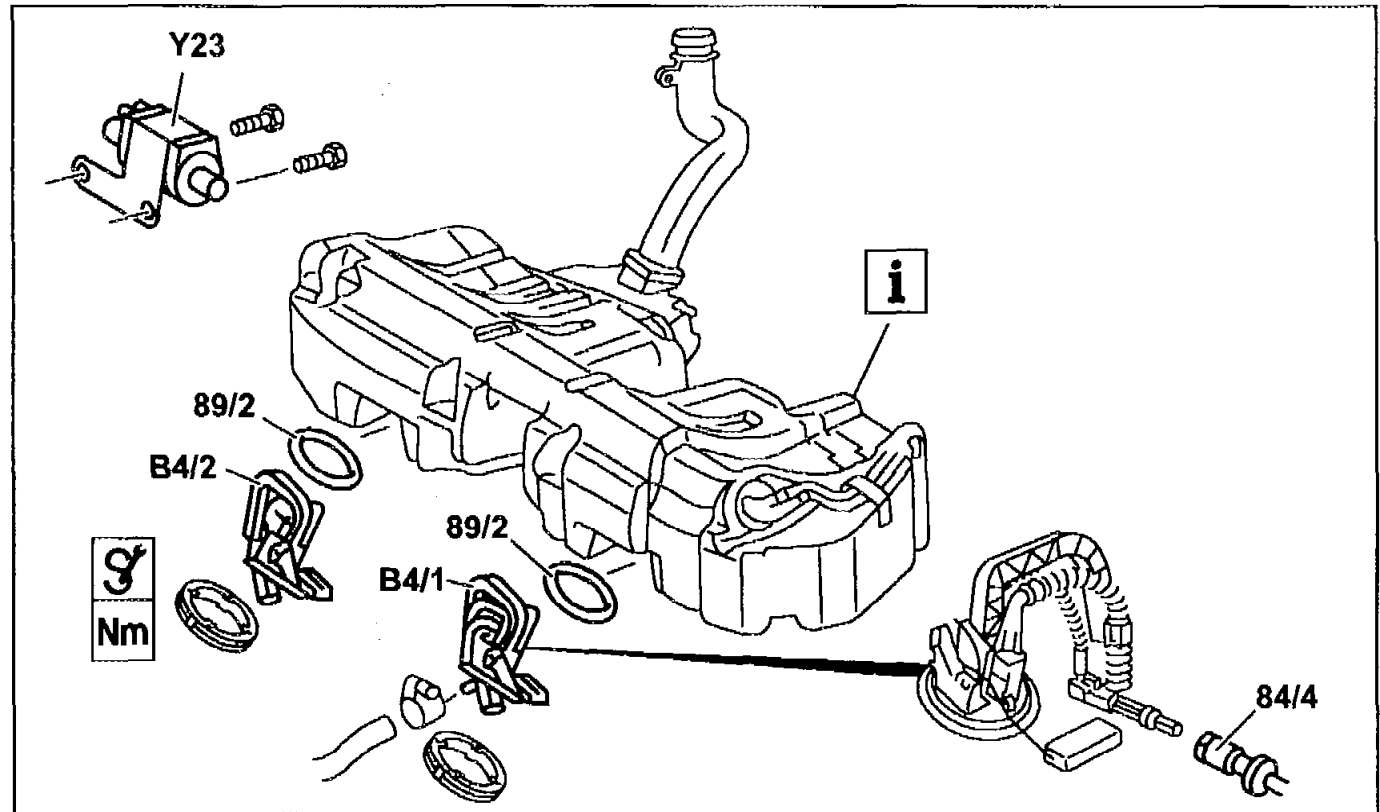

P47.10-0400-05

Modification notes

12.8.97	Unbolting fuel metering pump (Y23) on model 202.133/193		
---------	---	--	--

Fig. item, etc.	Work instructions		
-----------------	-------------------	--	--



Danger!	Risk of explosion as a result of fuel vapors igniting. Risk of poisoning as a result of inhaling fuel vapors. Risk of injury as a result of fuel coming into contact with skin and eyes.	No fire, naked flame or smoking. Pour fuels only into suitable and appropriate marked containers. Wear protective clothing when handling fuel.	AS47.00-Z-0001-01A D17
i	Drain fuel tank, fill		AR47.10-P-4001E K1
Nm 	Ring nut	Unscrew with pin wrench, screw on	BA47.10-P-1004-01A 202 589 00 07 00
B4/1	Fuel gauge sender	Installation note Fit the pipes (84/4) of suction jet pump onto fuel gauge sender (B4/1). Insert fuel gauge sender with pins into slots of the fuel tank. Replace sectional sealing ring (89/2)	

Fuel tank

Number	Designation		Model 202	Model 208
BA47.10-P-1004-01A	Ring nut for fuel gauge sender	Nm	55	55

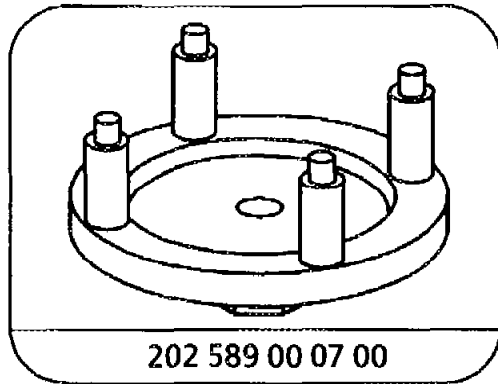

Pin wrench