

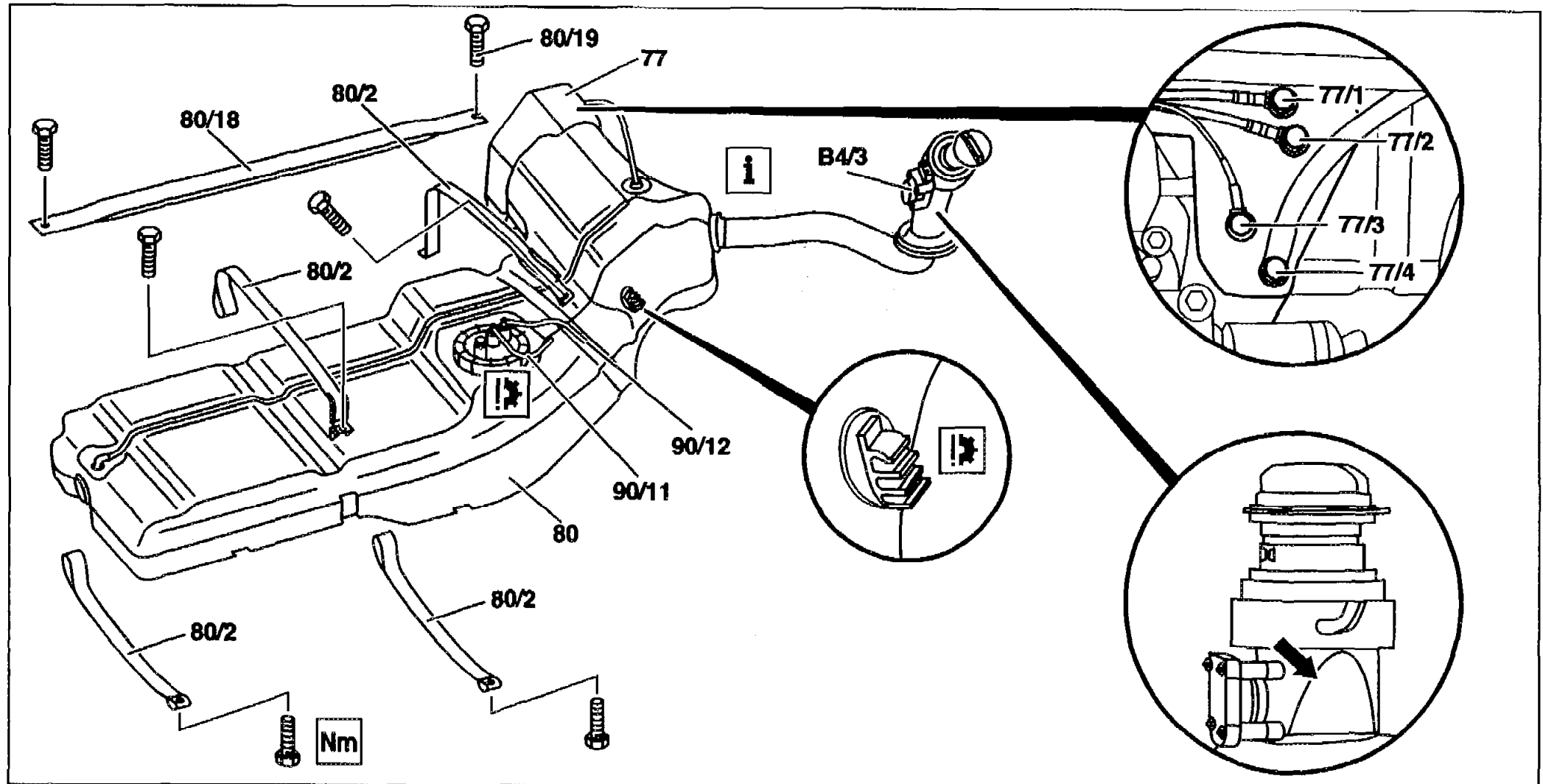





L3	AR47.10-P-4100GH	Removing and installing fuel tank	10.3.97
----	------------------	-----------------------------------	---------

MODEL 163.136 with ENGINE 111.977
MODEL 163.154 with ENGINE 112.942
MODEL 163.172 with ENGINE 113.942





77	Activated charcoal canister	77/4	Fresh air connection	80/19	Securing bolt
77/1	Fine vent connection	80	Fuel tank	90/11	Fuel return flow line
77/2	Purge connection	80/2	Tensioning straps	90/12	Fuel feed line
77/3	Spring chamber vent connection	80/18	Longitudinal strut for tensioning straps	B4/3	Pressure sensor (USA)

 Danger!	Removing, installing		
	Risk of explosion from ignition. Risk of poisoning from inhaling and swallowing fuel. Risk of injury as a result of fuel coming into contact with skin and eyes.	No fire, naked flame or smoking. Pour fuels only into suitable and appropriately marked containers. Wear protective clothing when handling fuel.	AS47.00-Z-0001-01A D17
1	Empty fuel tank	If fuel pump faulty  Pay attention to capacity	AR47.10-P-4001GH B2 AR47.10-P-4000GH D1 BF47.10-P-1001-01A
2.1	Remove pressure sensor (B4/3)	Only (USA)	AR47.10-P-8022GH
3	Guide filler neck down through vehicle floor	 Guide filler neck through between frame and body with its angled side (arrow). Filler neck and fuel tank cannot be separated.	
4	Remove spare wheel completely with spare wheel bracket	 Only on models with spare wheel on vehicle floor	
5	Disconnect lines (77/2, 77/3, 77/4) at activated charcoal canister	 Activated charcoal canister and fuel tank form a unit	

		<p>i Installation: fit on lines according to connection diagram:</p> <p>Engine 111</p> <p>Engine 112, 113</p> <p>Engine 112, 113 version (USA)</p>	<p>AR47.30-P-8212-01GJ A15</p> <p>AR47.30-P-8212-01GI B15</p> <p>AR47.30-P-8212-01GH C15</p>
6	Remove shield of rear exhaust system		
7	Unclip both rear brake cables at vehicle floor and unbolt brake cable holders on right and left at frame		
8	Disconnect rear propshaft at rear axle center section	<p>i Tie up propshaft e.g. with wire</p> <p>Nm</p>	BA41.10-P-1002-01C
9	Remove trim of rear left frame		
10	Remove tensioning straps (80/2)	<p>i Tensioning straps are color-coded, cannot be mixed up. Support fuel tank with inspection pit lift.</p> <p>Nm</p>	BA47.10-P-1001-01D
11	Remove longitudinal strut (80/18)	<p>Nm</p>	BA47.10-P-1002-01D
12	Unbolt rear axle carrier from frame floor and lower as far as possible	<p>i Likewise support rear axle carrier</p>	



			BA35.10-P-1001-01C
13	Unclip lines at side of fuel tank	Lines must not be damaged	
14	Unplug electric connector of fuel pump	Lower inspection pit lift about 20 cm for this step	
15	Disconnect fuel feed line (90/12) and return flow line (90/11)	Fuel lines must not be kinked 	163 589 00 37 00
16	Install in the reverse order		
17	Dispose of fuel tank Disposing of fuel tanks		OS OS47.10-P-0001-01A F18

Rear axle carrier

Number	Designation	Model 163
BA35.10-P-1001-01C	Self-locking bolt of rear axle carrier at front and rear to frame floor	Nm 170

Propeller shaft

Number	Designation	Model 163
BA41.10-P-1002-01C	Self-locking bolt of rear propshaft to rear axle center section	Nm 50

Nm Fuel tank

Number	Designation		Model 163
BA47.10-P-1001-01D	Bolts for tensioning straps	Nm	20
BA47.10-P-1002-01D	Longitudinal strut for tensioning straps	Nm	20

☒ Fuel tank

Number	Designation		Model 163
BF47.10-P-1001-01A	Tank capacity	Total capacity	Liters 72
		Reserve capacity	Liters 10

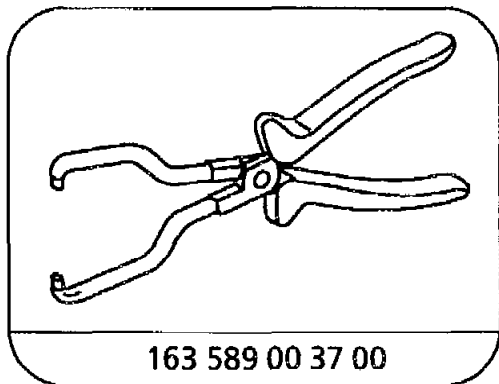

Pliers