

K2

AR47.10-P-4100BA





Removing and installing fuel tank



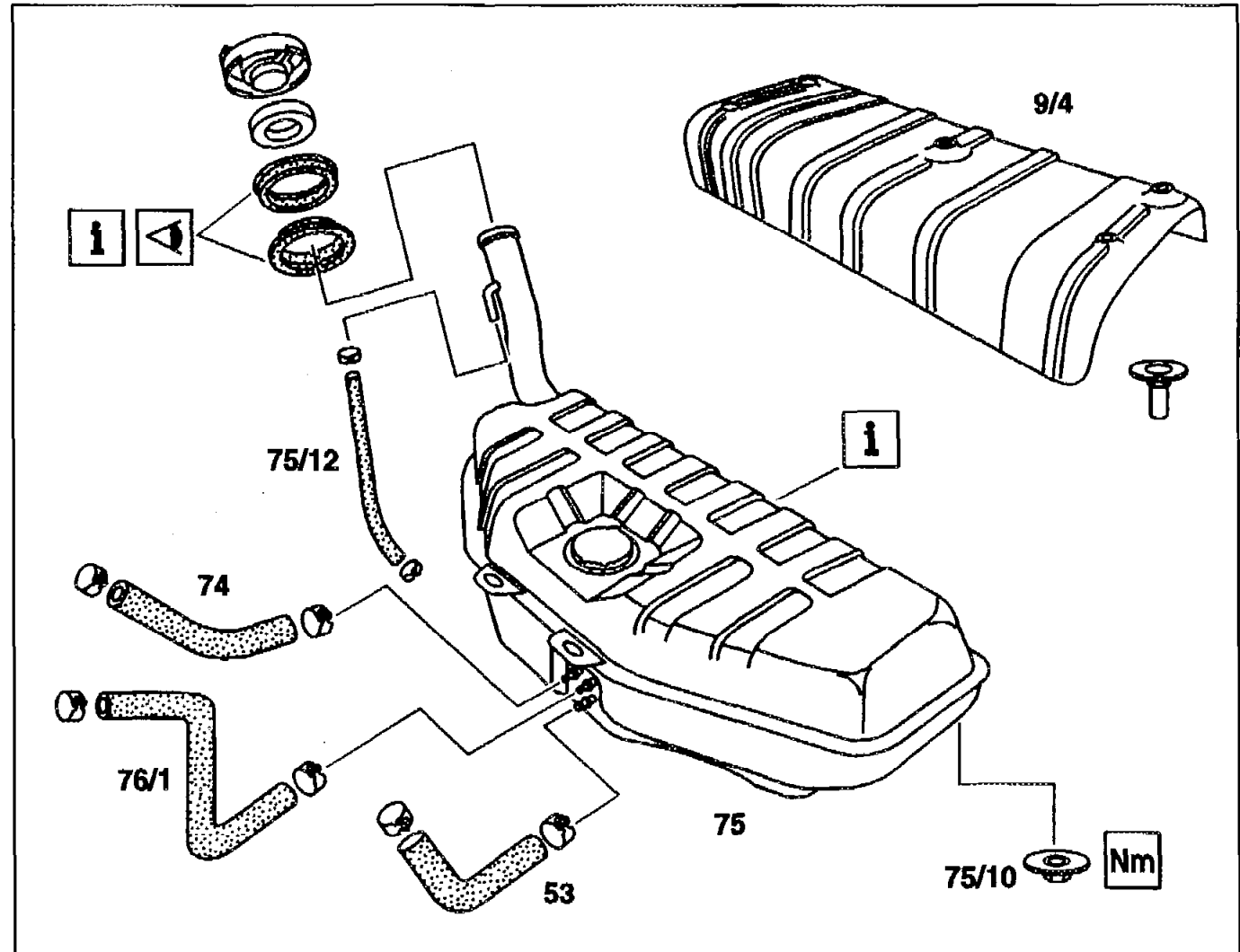

29.11.95

MODEL 210.206 /210 /217 /225 /235 /237 /245 /265 /270 /274 /281 /282

- 9/4 Shield
- 53 Fuel line at suction side
- 74 Fuel return flow line
- 75 Fuel tank
- 75/10 Nuts
- 75/12 Overflow line
- 76/1 Vent line



	Removing, installing		
 Danger!	Risk of explosion from ignition. Risk of poisoning from inhaling and swallowing fuel. Risk of injury as a result of fuel coming into contact with skin and eyes.	No fire, naked flame or smoking. Pour fuels only into suitable and appropriately marked containers. Wear protective clothing when handling fuel.	AS47.00-Z-0001-01A D17
1	Empty fuel tank (75), fill	 Pay attention to capacity	AR47.10-P-4001B H1 BF47.10-P-1001-01A
2	Remove right side trim in trunk		
3	Detach overflow line (75/12) at filler neck		
4	Unplug connector of fuel gauge sender in trunk		
5	Remove exhaust system complete	Model 210.206 Model 210.210/217/225/235/237/245	AR49.10-P-7000HB AR49.10-P-7000BA
		Model 210.265/070/270/274/281/282	AR49.10-P-7000A
6	Remove shield (9/4)		
7	Detach fuel line at suction side (53), fuel return flow line (74) and vent line (76/1)	 Collect remaining fuel and seal connections. Unclip vent hose at fuel tank.	

8	Take off nuts (75/10) and take out fuel tank (75) downward together with cup seals	 Inspect whether cup seals can be re-used.  Installation: when inserting, ensure that the cup seals are correctly fitted.  Nm	BA47.10-P-1005-01B
9	Install in the reverse order		
10	Dispose of fuel tank		
 OS	Disposing of fuel tanks		OS47.10-P-0001-01A F18

 Fuel tank

Number	Designation	Model
BA47.10-P-1005-01B	Self-locking nut to fuel tank	Nm 30

 Fuel tank

Number	Designation	Models 210.210/ 217/225/235/ 237/245/265/ 270/274/281/282
BF47.10-P-1001-01A	Tank capacity	
	total capacity	liters 70
	reserve capacity	liters 9