

<b>G2</b>	AR30.10-P-1010G	<b>Adjusting accelerator control</b>	<b>12.12.94</b>
-----------	-----------------	--------------------------------------	-----------------

**ENGINE 111.946 in MODEL 170**

**ENGINE 111.921 /945 /974 in MODEL 202**

**ENGINE 111.945 in MODEL 208**

**ENGINE 111.942 /970 in MODEL 210**



Shown on engine 111 in model 210

- 24 Accelerator pedal
- 30 Accelerator control cable
- 30/2 Adjusting nut
- 30/3 Adjusting screw
- 30/5 Guide piece
- 30/7 Driver spring
- 32/4 Connecting rod
- 32/5 Bell crank
- 32/6 Fulcrum lever
- 32/7 Control lever
- 32/8 Roller
- 32/10 Roller in fulcrum lever for control pressure cable, on AT
- 38 Variable full throttle stop
- 98 Control pressure control cable
- 98/2 Adjusting screw
- S16/7 Kickdown switch, 2nd transmission mode

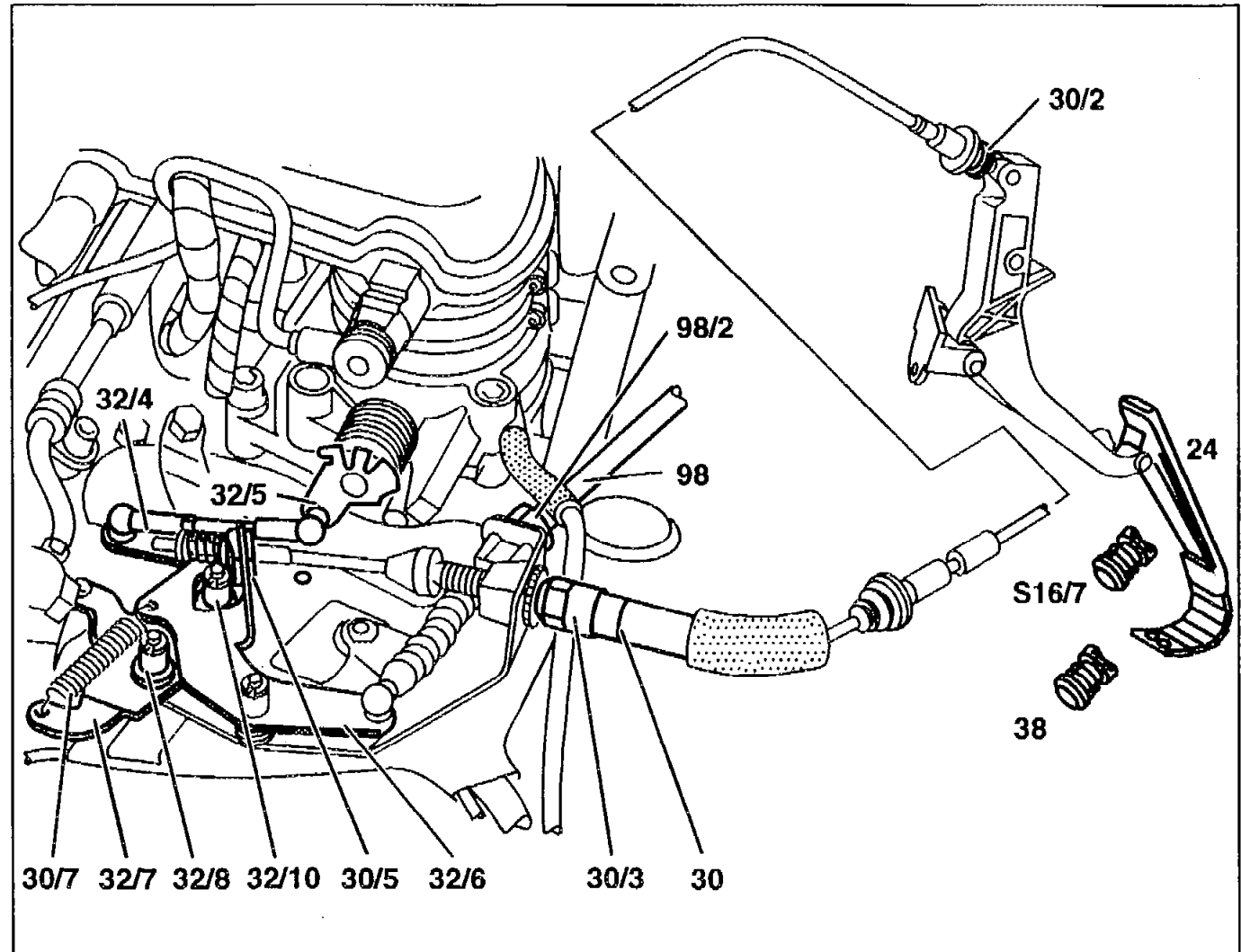

P30.10-0248-06

	<b>Adjusting</b>		
	Ignition: OFF		

1	Inspect connecting rods (32/4) and accelerator control cable (30) to ensure they operate freely and are in proper condition	Replace parts, if necessary	
2	Check play between driver spring (30/7) and guide piece (30/5), adjust	There must be play between driver spring (30/7) and guide piece (30/5). Adjust with adjusting screw (30/3), if necessary	BE30.10-P-1001-01A
3	Detach connecting rod (32/4) at bell crank (32/5) and check closed throttle position (idle) stop		
4	Press bell crank (32/5) onto cylinder head with screwdriver	<p><b>i</b> Against spring force in actuator. Position connecting rod (32/4) at ball pin free of tension (figure), press on, adjust if necessary. Attach connecting rod (32/4) and lock.</p> <p><b>i</b> The connecting rod (32/4) must be adjusted very accurately.</p>	
5	Adjust control pressure control cable (98)	With control pressure control cable attached, turn adjusting screw (98/2) until the tip of the drag lever is at the same level as the tip of the fulcrum lever (32/6)	



6.1	Checking full throttle stop, adjusting	<b>Manual transmission:</b> With engine switched off, depress accelerator pedal (24) to full throttle stop. Bell crank (32/5) must be resting against full throttle stop of idle speed control actuator. Release variable full throttle stop (38), if necessary, by turning to the left. Pull out stop pin slightly, lock full throttle stop (38) in position by turning to the right.	
6.2		<b>i Automatic transmission:</b> With engine switched off, depress accelerator pedal (24) to full throttle stop at kickdown switch (S16/7) (do not operate kickdown switch). Bell crank (32/5) must just be resting against full throttle stop of idle speed control actuator; set with adjusting screw (30/3), if necessary	
7	Checking idle speed adjustment at chassis end, adjusting	Accelerator pedal (24) in idle speed position. There must be play between driver spring (30/7) and guide piece (30/5); adjust from inside car with adjusting nut (30/2), if necessary	
8	Grease accelerator control cable (30) between end piece and guide piece (30/5) with anti-corrosion grease		BR00.45-Z-1007-06A

**Test values of accelerator control**

Number	Designation	Model 111
BE30.10-P-1001-01A	Play of accelerator control cable between driver spring and guide piece at fulcrum lever	mm 0,5–1,0

**Repair product**

Number	Designation	Order number
BR00.45-Z-1007-06A	Anti-corrosion grease	001 989 37 51 10