



N3	AR09.20-P-1310G	Removing and installing intake manifold	3.8.94
-----------	-----------------	--	---------------

**ENGINE 111.920 /940 /941,
111.944 up to 31.8.96,
111.960 /961,
111.975 up to 31.8.96**



- 15/1 Bolt of power steering pump bracket
- 19 Intake manifold
- 19/1 Bolt
- 19/2 Nut
- 19/3 Gasket
- 19/4 Bolt of intake manifold support
- 30/4 Plastic clip
- 30/5 Guide piece
- 32/3 Bracket of throttle control lever
- Arrow Connector

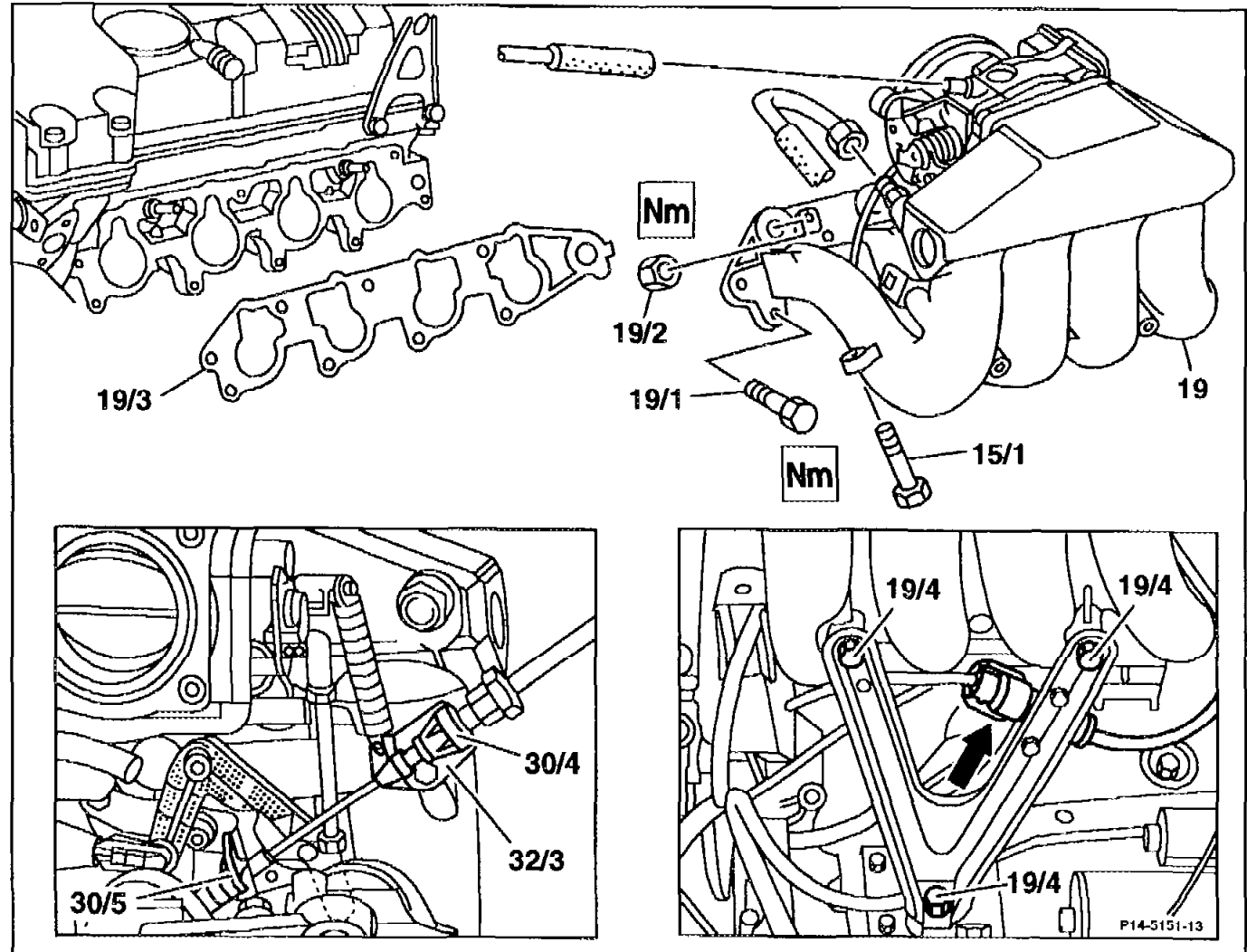

P09.20-0223-06

	Removing, installing		
1	Remove air cleaner cross pipe		AR09.10-P-8031G N2

2	Remove fuel rail together with injection valves		AR07.03-P-1450D	B1
3	Unbolt ignition coils		AR15.12-P-2003G	O7
4	Disconnect vacuum pipes	<p>i Installing: ↓</p> <p>Connect vacuum pipes as shown in connecting diagram</p> <p>Engine 111.940/960/961, 111.920/941/944 up to 08/96</p> <p>Engine 111.920/941/944 as of 09/96</p>	AR09.20-P-1310-01G	F16
			AR09.20-P-1310-01GB	L16
5	Unscrew bolt (15/1) for power steering pump bracket			
6	Unscrew bolts (19/4) for intake manifold support			
7	Separate connector (arrow) for idle speed control (ISC) at intake manifold supporting bracket			
8	Take off bracket for starter wiring harness	Model 124		
9	Remove guide piece (30/5)	<p>First of all, pull plastic nipple out of guide piece</p> <p>i Installing: ensure that the plastic nipple is properly engaged in the guide piece</p>		

10	Compress plastic clip (30/4), pull control cable out of bracket of throttle control lever (32/3)		
11	Slacken nuts and bolts (19/1, 19/2) and take out intake manifold (19)	Nm i Installing: replace gasket (19/3)	BA09.20-P-1001-01B
12	Install in reverse sequence		
13	Check idle speed, adjust	See DM Engine, Volume 1/Register B	
14	Check throttle control, adjust	Idle speed stop, full throttle stop	AR30.10-P-1010D

Nm Intake manifold

Number	Designation	Engine 111
BA09.20-P-1001-01B	Bolts and nuts of intake manifold on cylinder head	Nm 20